

SPECIFICATION	
Number of Circuit	3 amps/circuit (22AWG), 10 amps/2circuit(16AWG)
Operating Speed	100rpm continuous
Lead Lengths	300mm
Voltage	Max. 380VDC/VAC
Current Rating	12 ~ 32 circuit
Contact Material	Gold to Gold
Lead Size/Type	Silver plated copper Type Teflon Insulated
Noise	100milliohms max

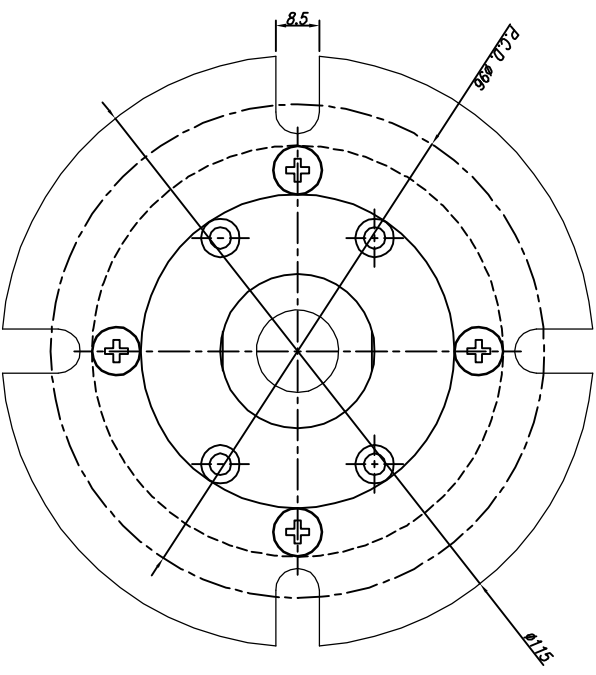
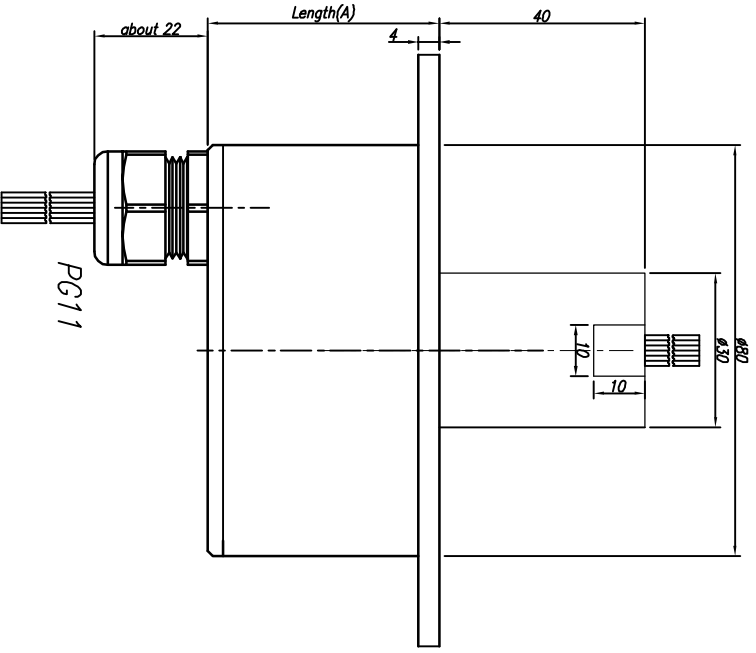

VIEW - TOP

NO	PART NAME	CHECKED	APPROVE	MATERIAL	QTY	COATING METHOD	REMARK
01	WR-S000(B Type)						
DRAWING		DESIGN		PRINT SCALE	SIZE	PROJECTION	
LEE.Y.S		KIM.W.B	KIM.W.B	N : S	A3		
TOLERANCE				DATE			
0 ~ 10			+0.02	2013.02.04			
11 ~ 30			+0.05				
31 ~ 50			+0.10				
51 ~ 100			+0.15				
100 ~			+0.20				
CHAMFER			C = 0.3				
FILET			R = 0.3				
ANGLE			40°/20				
HOLE PITCH			+0.05				
DRAWING NO.		WR-S000-00-B		1		1	

우리슬리밍

도면번호	Port	Length(A)
WR-S012-00-B	12	62.6
WR-S024-00-B	24	91.4
WR-S032-00-B	32	110.6