

NO.	DESCRIPTION	MAKER	MODEL No.
-----	-------------	-------	-----------

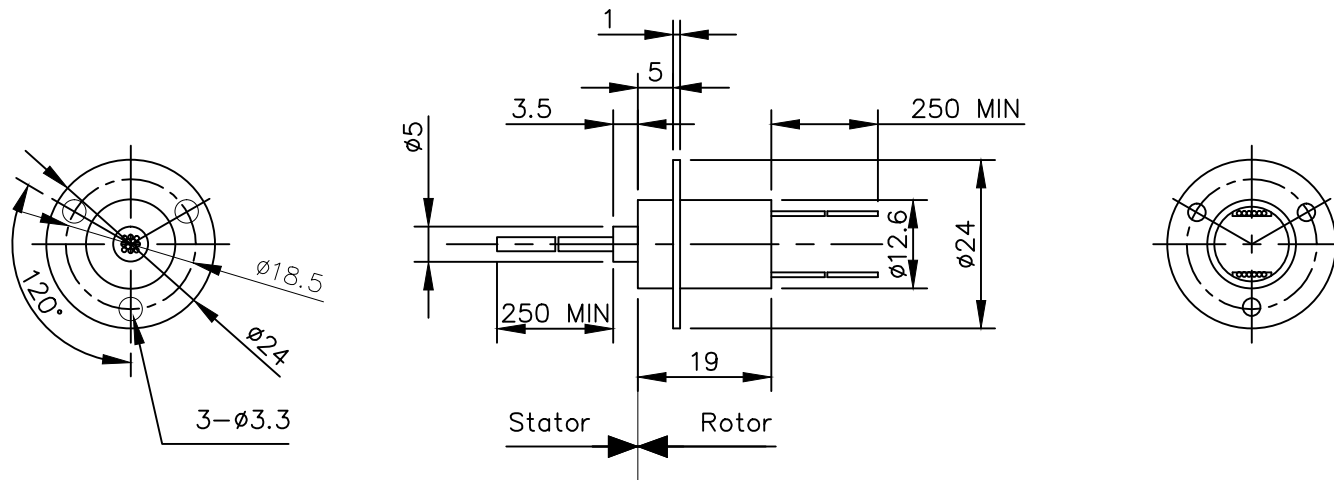

NOTE.

- Speed : 0-250 RPM
 - Number of Ring : 6
 - Voltage : 210VDC & 240VAC
 - Current : 3Amp per Circuit, Maximum
 - Contact Material : Gold to Gold
 - Temperature : -40℃ ~ +80℃
 - Leadwire : #26 AWG, UL Teflon Wire(Silver Plated Copper)
 - Rotation : Bi-Directional
 - Insulation Resistance : 1000 Megohms Min. at 500 VDC
 - Dielectric Strength : Between each circuit and all other circuits
 - Electrical noise : 70 Milliohm Max. tested
@5 rpm
- 250VAC @50Hz
@6 VDC, 50 milliamps when running

NO.	COLOR
1	검정
2	빨강
3	노랑
4	초록
5	파랑
6	백색

01	WR-MS06							
NO	PART NAME	MATERIAL	Q'TY	COATING METHOD	REMARK			
DRAWING	DISIGN	CHECKED	APROVE	PRINT SCALE	SIZE	PROJECTION		
LEE.Y.S		KIM.W.B	KIM.W.B	N : S	A3			
				DATE	2022.04.01	우리슬립링 DRAWING NO. WR-MS06		
TOLERANCE	0 ~ 10	±0.02	CHAMFER	C = 0.3				
	11 ~ 30	±0.05	FILLET	R = 0.3				
	31 ~ 50	±0.10	ANGLE	±0°20'				
	51 ~ 100	±0.15	HOLE PITCH	±0.05				
100 ~	±0.20							
						1	1	