

NO.	DESCRIPTION	MAKER	MODEL No.
-----	-------------	-------	-----------

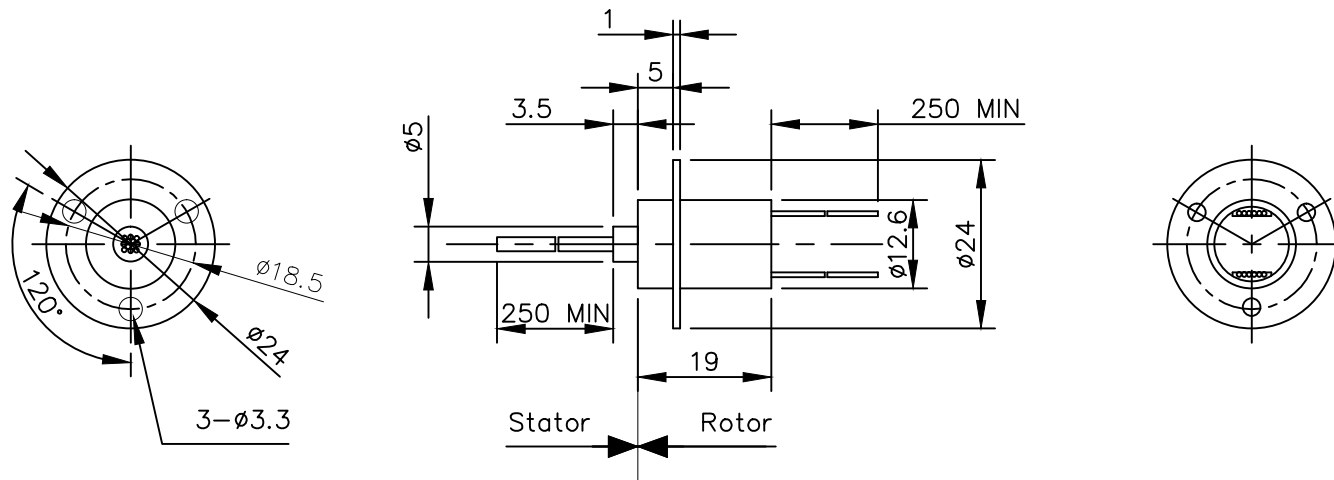

NOTE.

1. Speed : 0-250 RPM
  2. Number of Ring : 4
  3. Voltage : 210VDC & 240VAC
  4. Current : 3Amp per Circuit, Maximum
  5. Contact Material : Gold to Gold
  6. Temperature : -40℃ ~ +80℃
  7. Leadwire : #26 AWG, UL Teflon Wire(Silver Plated Copper)
  8. Rotation : Bi-Directional
  9. Insulation Resistance : 1000 Megohms Min. at 500 VDC
  10. Dielectric Strength : Between each circuit and all other circuits
  11. Electrical noise : 70 Milliohm Max. tested
- 250VAC @50Hz  
@6 VDC, 50 milliamps when running
- @5 rpm

NO.	COLOR
1	검청
2	빨강
3	노랑
4	초록

01	WR-MS04							
NO	PART NAME		MATERIAL	Q'TY	COATING METHOD		REMARK	
DRAWING	DISIGN	CHECKED	APROVE	PRINT SCALE	SIZE	PROJECTION		
LEE.Y.S		KIM.W.B	KIM.W.B	N : S	A3	 <b>우리슬립링</b>		
				DATE	2022.04.01			
TOLERANCE	0 ~ 10	±0.02	CHAMFER	C = 0.3		DRAWING NO. WR-MS04		
	11 ~ 30	±0.05	FILLET	R = 0.3				
	31 ~ 50	±0.10	ANGLE	±0°20'				
	51 ~ 100	±0.15	HOLE PITCH	±0.05				
	100 ~	±0.20						
							1	1