

NO.	DESCRIPTION	MAKER	MODEL No.
-----	-------------	-------	-----------

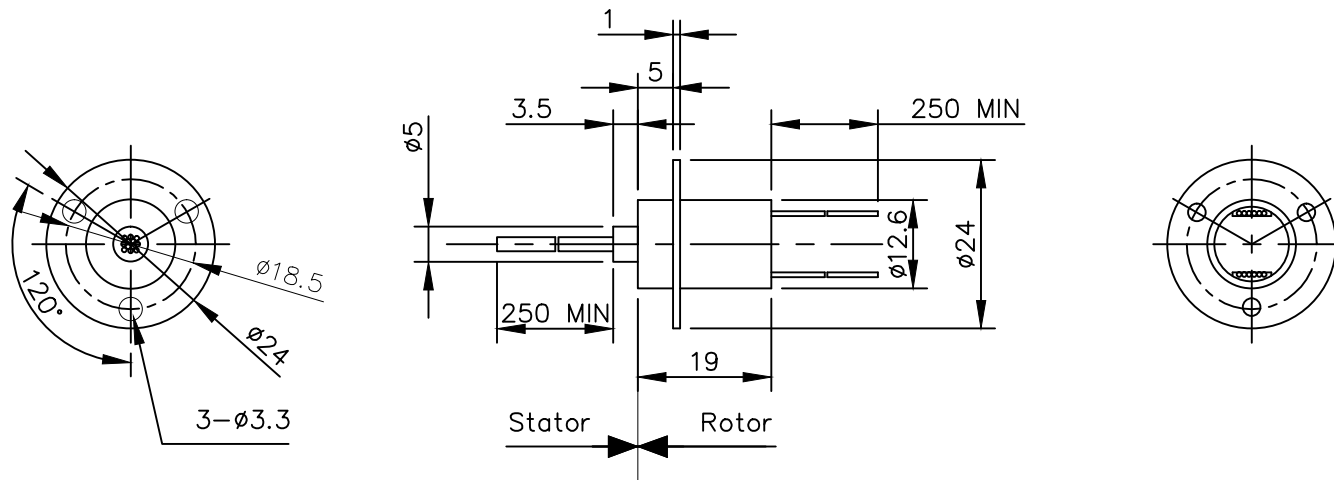

NOTE.

- Speed : 0-250 RPM
 - Number of Ring : 12
 - Voltage : 210VDC & 240VAC
 - Current : 2Amp per Circuit, Maximum
 - Contact Material : Gold to Gold
 - Temperature : -40℃ ~ +80℃
 - Leadwire : #30 AWG, UL Teflon Wire(Silver Plated Copper)
 - Rotation : Bi-Directional
 - Insulation Resistance : 1000 Megohms Min. at 500 VDC
 - Dielectric Strength : Between each circuit and all other circuits
 - Electrical noise : 70 Milliohm Max. tested
@5 rpm
- 250VAC @50Hz
@6 VDC, 50 milliamps when running

NO.	COLOR	NO.	COLOR
1	검정	7	보라
2	빨강	8	회색
3	초록	9	노랑
4	주황	10	갈색
5	파랑	11	투명
6	백색	12	분홍

01	WR-M012							
NO	PART NAME		MATERIAL	Q'TY	COATING METHOD		REMARK	
DRAWING	DISIGN	CHECKED	APROVE	PRINT SCALE	SIZE	PROJECTION		
LEE.Y.S		KIM.W.B	KIM.W.B	N : S	A3			
				DATE	2013.02.04			
TOLERANCE	0 ~ 10	±0.02	CHAMFER	C = 0.3		DRAWING NO. WR-M012-01		
	11 ~ 30	±0.05	FILLET	R = 0.3				
	31 ~ 50	±0.10	ANGLE	±0°20'				
	51 ~ 100	±0.15	HOLE PITCH	±0.05				
	100 ~	±0.20						
							1/1	